

# NOZZLE FILTERS

Compatible with the most common types of nozzle holders, Lurmark's range of nozzle filters are colour coded for easy identification. The ball check filters provide an anti-drip facility in the absence of diaphragm check valves.

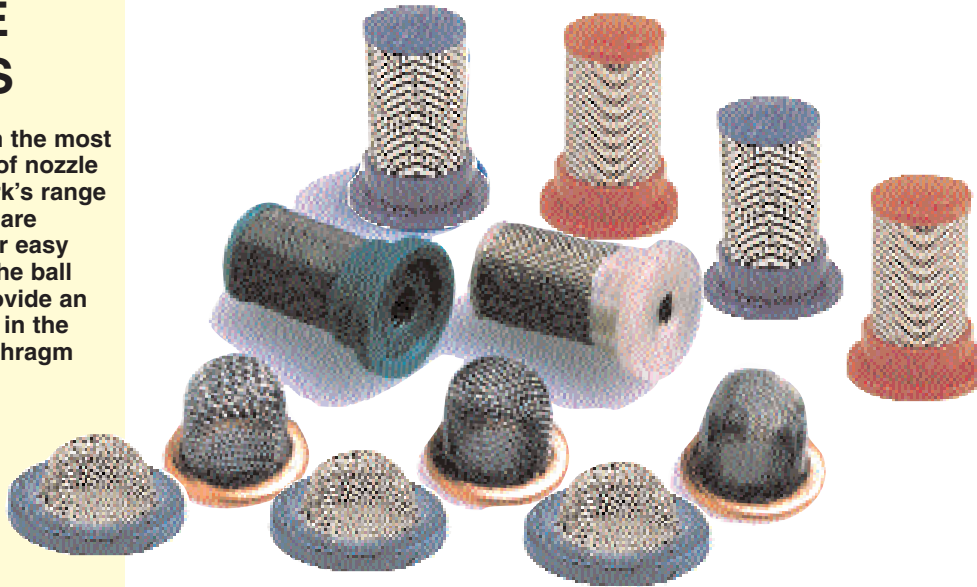

## BALL CHECK FILTERS (ANTI-DRIP)

Ball Check Filter in Acetal with stainless steel screen. Provides limited anti-drip facility for non-DCV nozzles

Fitted with nitrile balls

30 mesh (coarse), white  
Part No. **32100530**

50 mesh (medium), blue  
Part No. **32100550**

100 mesh (fine), green  
Part No. **32100510**

200 mesh (v.fine), yellow  
Part No. **32100520**

## CUP FILTER (COPPER FLANGE)

Cup Filter with copper flange and s/steel screen

30 mesh (coarse)  
Part No. **32100630**

50 mesh (medium)  
Part No. **32100650**

100 mesh (fine)  
Part No. **32100610**

200 mesh (v.fine)  
Part No. **32100620**

## CUP FILTER (NYLON FLANGE)

Cup Filter with nylon flange and stainless steel screen

30 mesh (coarse)  
Part No. **3230A245**

50 mesh (medium)  
Part No. **3250A245**

100 mesh (fine)  
Part No. **3210A245**

## STANDARD FILTER

Standard Nozzle Filter in Acetal with stainless steel screen.

50 mesh (medium), blue  
Part No. **32100050**

100 mesh (fine), green  
Part No. **32100010**

200 mesh (v.fine) yellow  
Part No. **32100020**

## CUP FILTER IN MOULDED POLYPROPYLENE.

30 mesh (coarse) white  
Part No. **3210063P**

50 mesh (medium) blue  
Part No. **3210065P**

**SPRAY NOZZLES**  
Please refer to Section 2 for details of Lurmark's complete range of spray tips and nozzles

## MESH REFERENCE CHART

Mesh	Mesh Opening (Microns)	Wire Diameter (Microns)	Ratio of Mesh Opening Surface to Surface %	Material Mesh
Total				
16	980	490	44.4	Polypropylene
16	1320	220	73.3	Stainless Steel
32	500	320	37.1	Polypropylene
32	594	200	55.3	Stainless Steel
50	365	140	50.8	Stainless Steel
80	229	80	55.7	Stainless Steel
100	173	80	46.4	Stainless Steel
120	134	70	43	Poliamide
120	144	70	45.4	Stainless Steel
150	96	65	35	Poliamide
150	114	70	42.4	Stainless Steel

## Foot Filters



- \* Ideal for providing first stage of filtration.
- \* Coarse mesh prevents very large particles being drawn from the liquid storage tank.
- \* Size and shape allow easy positioning without damaging the tank walls.

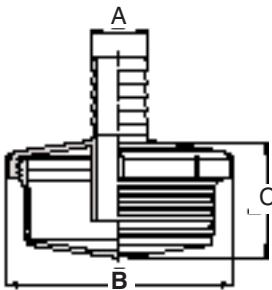

A mm	B mm	C mm	Part Number
19	60	47	08302019
19	60*	47	08302019.1
15	100	54	08302115
20	100	54	08302120
22	100	54	08302122
25	100	54	08302125
25	125	76	08302225
30	125	76	08302230
30	150	96	08302330
35	150	96	08302335
40	150	96	08302340
50	150	96	08302350
G1/4 M(BSP)	150	96	08302-05

\*With non-return valve

## Compact Foot Filters

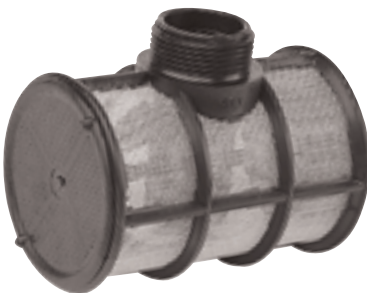

Port BSP (M)	Mesh	Part Number
1 1/4"	16	0831A367
1 1/2"	16	0831A368
2"	16	08325A369

\*Polypropylene body and filter mesh

## Line Filters



### 1/2" & 3/4" LINE FILTERS AND SPARES

- \* 1/2" and 3/4" BSP threads
- \* Max. working pressure 14 bar
- \* Filtering capacity 80 -100 L/min
- \* Cartridge Ø 38 x 89 mm
- \* Fixing points on both sides
- \* Polypropylene body
- \* EPDM gaskets.

#### Components Part Numbers

1/2" Hood	2101BH12
3/4" Hood	2101BH34
Bowl	2101BOBO
Hood O ring	2101BOTO
Element O ring x 2	2101BOEO
32# Element	2112B030
50# Element	2113B050
80# Element	2113B057
200# Element	2113B200

### 1" LINE FILTERS AND SPARES

- \* 1" BSP threads
- \* Max. working pressure 14 bar
- \* Filtering capacity 150 - 160 L/min
- \* Cartridge Ø 38 x 125 mm
- \* Fixing points on both sides
- \* Polypropylene body
- \* EPDM gaskets.

#### Components Part Numbers

1" Hood	2101BH10
Bowl	213224000-020
Hood O ring	21G11017
Element O ring x 2	2101BOEO
Retaining nut	213224000-050
32# Element	21323002
50# Element	21323003
80# Element	213230035

### PART NOS. 1/2" AND 3/4" LINE FILTERS

Part No	Port F (BSP)	Screen Type	Filter Length (mm)	Effective Area	
				cm <sup>2</sup>	in <sup>2</sup>
20N62230	1/2	32 mesh	21	30	4.7
20N62250	1/2	50 mesh	21	28	4.3
20N62280	1/2	80 mesh	21	25	3.9
20N62220	1/2	200 mesh	21	20	3.1
20N62330	3/4	32 mesh	23	30	4.7
20N62350	3/4	50 mesh	23	28	4.3
20N62380	3/4	80 mesh	23	25	3.9
20N62320	3/4	200 mesh	23	20	3.1

### PART NOS. 1" LINE FILTERS

Part No	Port F (BSP)	Screen Type	Filter length mm	Effective Area	
				cm <sup>2</sup>	in <sup>2</sup>
20N62430	1	32 mesh	23	41	6.4
20N62250	1	50 mesh	23	38	5.9
20N62480	1	80 mesh	23	34	5.3

## FILTERS

To prevent pump damage and blocked nozzles, Lurmark can provide a range of filters to suit all applications. Normally, filtration should be applied in stages, ranging from, coarse in the liquid reservoir through to fine just before the nozzle. Please see page 40 for details of nozzle filters.

Mesh sizes can be varied depending on the flow rate of the liquid being sprayed.



## Line Filters

### 1 1/4" & 1 1/2" LINE FILTERS STANDARD FLUSHING AND SPARES

- \* 1 1/4" and 1 1/2" BSP threads
- \* Max. working pressure 15 bar
- \* Filtering capacity 200 - 280 L/min
- \* Cartridge Ø 58 x 210 mm
- \* Fixing points on both sides
- \* Polypropylene body
- \* EPDM gaskets
- \* Flushing option has a ball valve fitted to the bottom of the bowl.

#### Components Part Numbers

1 1/4" Hood	2101BH54
1 1/2" Hood	2101BH64
Bowl Flushing	213262300-020
Bowl Standard	213262000-020
Hood O ring	21G10090
Element O ring (x2)	2101AOEO
Retaining Ring	213262000-050
30# Element	21A63130
50# Element	21A63150
80# Element	21A63180
200# Element	21A63200
Washer Seal	01WSHR02
Ball Valve (flush version)	56454133

#### PART NOS. 1 1/4" & 1 1/2" LINE FILTERS

Part No Flushing	Part No Standard	Port Size (F) (BSP)	Screen Type	Effective Area	
				cm <sup>2</sup>	sq.in
20NF62530	20N62530	1 1/4	32 mesh	115	17.9
20NF62550	20N62550	1 1/4	50 mesh	106	16.4
20NF62580	20N62580	1 1/4	80 mesh	115	18.0
20NF62520	20N62520	1 1/4	200 mesh	77	11.9
20NF62630	20N62630	1 1/2	32 mesh	115	17.9
20NF62650	20N62650	1 1/2	50 mesh	106	16.4
20NF62680	20N62680	1 1/2	80 mesh	115	18.0
20NF62620	20N62620	1 1/2	200 mesh	77	11.9